

Elemento	Pos	Diam	Q	Dolo	Ret	Dolo	Comp	Total	CA-50	CA-60	
		(cm)	(cm)	(cm)	(cm)	(cm)	(cm)	(cm)	(kg)	(kg)	
P9	1	Ø12.5	6	14	198	14	200	1356	13.1		
	2	Ø12.5	6	14	198	14	200	1356	13.1		
	3	Ø12.5	14	30	359	30	359	5026	48.4		
	4	Ø12.5	26	336	336	336	336	8736	84.1		
	5	Ø12.5	4	30	132	160	160	640	6.2		
	6	Ø6.3	3	90	90	90	90	270	0.7		
Total=10282.2											
P10	7	Ø10	9	11	199	11	200	1800	11.1		
	8	Ø10	9	11	199	11	200	1800	11.1		
	9	Ø12.5	12	357	357	357	4284	41.3			
	10	Ø16	15	332	332	332	4980	78.6			
	11	Ø20	4	30	158	188	188	752	18.5		
	12	Ø6.3	3	90	90	90	270	0.7			
Total=10278.8											
P12	13	Ø10	9	11	199	11	200	1800	11.1		
	14	Ø10	9	11	199	11	200	1800	11.1		
	15	Ø12.5	12	357	357	357	4284	41.3			
	16	Ø16	15	332	332	332	4980	78.6			
	17	Ø12.5	20	127	157	157	214	3.0			
	18	Ø16	4	30	142	172	172	688	10.9		
19	Ø6.3	3	90	90	90	270	0.5				
Total=10273.5											
P13	20	Ø12.5	6	14	198	14	200	1356	13.1		
	21	Ø12.5	6	14	198	14	200	1356	13.1		
	22	Ø12.5	14	359	359	359	5026	48.4			
	23	Ø12.5	26	336	336	336	8736	84.1			
	24	Ø20	4	30	164	194	194	776	19.3		
	25	Ø6.3	3	100	100	100	300	0.7			
Total=10259.4											
P17	26	Ø10	10	11	199	11	200	2000	12.3		
	27	Ø10	10	11	199	11	200	2000	12.3		
	28	Ø12.5	12	357	357	357	4284	41.3			
	29	Ø16	15	332	332	332	4980	78.6			
	30	Ø12.5	4	30	127	157	157	680	6.0		
	31	Ø16	4	30	142	172	172	688	10.9		
32	Ø6.3	3	90	90	90	270	0.7				
Total=10276.8											
P18	33	Ø10	9	11	199	11	200	1800	11.1		
	34	Ø10	9	11	199	11	200	1800	11.1		
	35	Ø12.5	12	357	357	357	4284	41.3			
	36	Ø16	15	332	332	332	4980	78.6			
	37	Ø16	4	30	142	172	172	688	10.9		
	38	Ø6.3	3	90	90	90	270	0.7			
Total=10273.4											
P23	39	Ø10	9	11	199	11	200	1800	11.1		
	40	Ø10	9	11	199	11	200	1800	11.1		
	41	Ø12.5	12	357	357	357	4284	41.3			
	42	Ø16	15	332	332	332	4980	78.6			
	43	Ø12.5	4	30	127	157	157	680	6.0		
	44	Ø6.3	3	90	90	90	270	0.7			
Total=10273.0											
P26	45	Ø10	9	11	199	11	200	1800	11.1		
	46	Ø10	9	11	199	11	200	1800	11.1		
	47	Ø12.5	12	357	357	357	4284	41.3			
	48	Ø16	15	332	332	332	4980	78.6			
	49	Ø12.5	4	30	142	172	172	314	3.0		
	50	Ø16	4	30	142	172	172	688	10.9		
51	Ø6.3	3	80	80	80	240	0.6				
Total=10273.6											
									Ø6.3	6.1	0.0
									Ø10	54.0	0.0
									Ø12.5	648.0	0.0
									Ø16	566.4	0.0
									Ø20	41.4	0.0
											0.0
											0.0
											0.0

Resumo Aço	Subsídio	Comp. total	Peso+10%	Total
Detalhamento fundação	(cm)	(kg)	(kg)	
CA-50	Ø6.3	118.8	32	
	Ø8	312.5	136	
	Ø10	1235.1	837	
	Ø12.5	2969.7	3146	
	Ø16	2257.5	3920	
	Ø20	217.6	590	
	Ø25	172.2	730	9391
CA-60	Ø4.2	17.8	2	
Total				9393

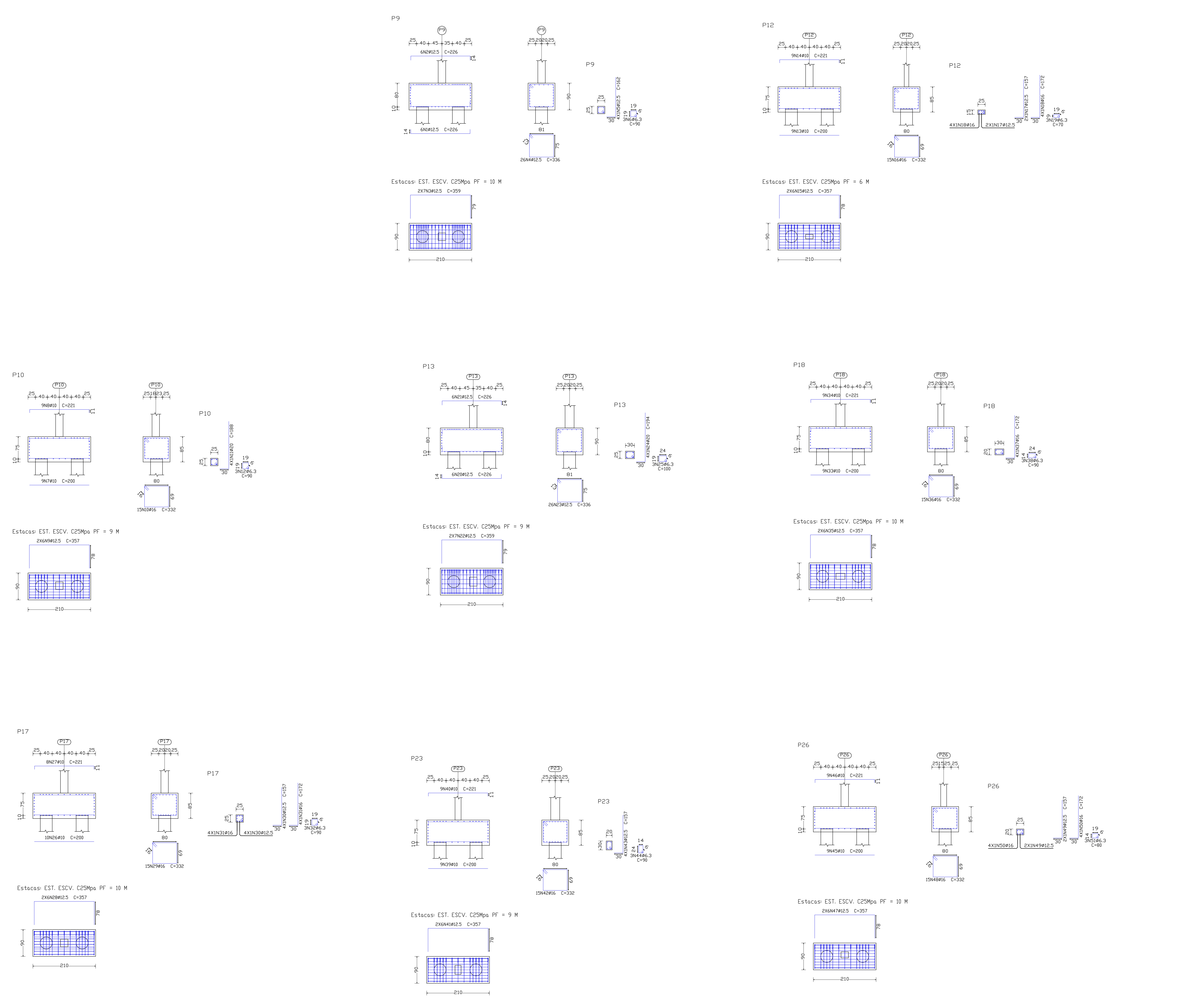

**ESTRUTURAL**  
DETALHAMENTO FUNDAÇÃO

**IPI** DLN ENGENHARIA E ARQUITETURA  
CNPJ: 43.208.900/00-00  
AVENIDA JOCKEY CLUB, 448 - JARDIM JOCKEY CLUB - LONDRIANA PR  
FONE: (43)9960-4704  
EMAIL: DLNENGENHARIA E ARQUITETURA@GMAIL.COM

**dlm**  
LARISSA MEIRELES  
ARQUITETA E URBANISTA  
CAU: A283386-8

INSTITUTO DE PREVIDÊNCIA DE ITAJAÍ - IPI / SC  
Rua Anna Carolina Zappaloni Gomes Silva de Souza, 55  
Itajaí / SC  
Ressacada

DATA: Outubro / 2023  
FONE: (43)3255-8600

FRANQUIA Nº: 02/07

DESENHO: LARISSA MEIRELES ESCALA: 1/50